

LBI SERIES

**End-suction Centrifugal Monoblock Pumps
50 Hz**

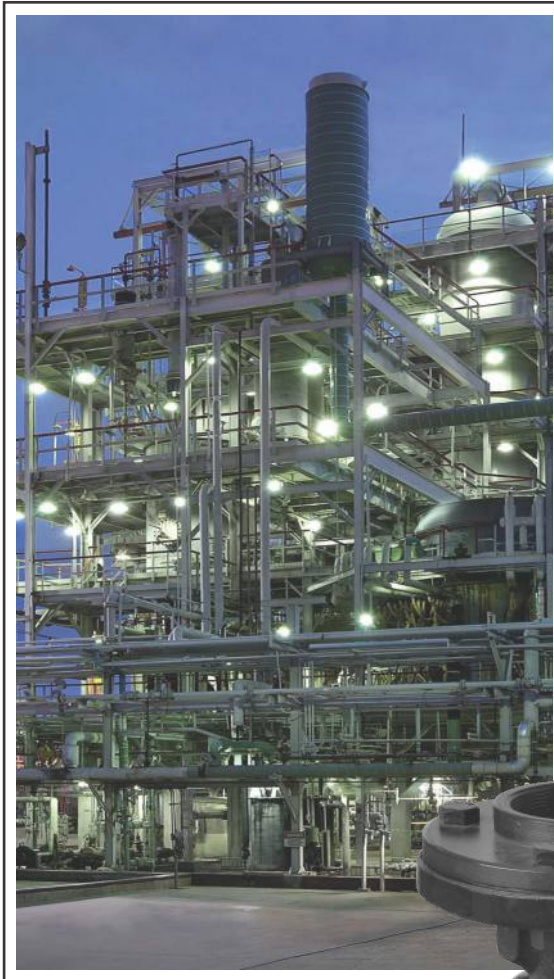

INTRODUCTION

The Lubi **LBI** series are non-self priming, horizontal, single-stage, centrifugal, end-suction pumps.

Pumps are available from 2.2 to 3.7 kW in single-phase and from 1.5 to 11 kW in three-phase power supply.

Motor and pump are close coupled in a convenient and compact design for quick installation in limited space.

The pump is fitted with a maintenance-free, mechanical shaft seal and single piece pump-motor shaft.

The pumps have axial suction port and radial discharge port.

APPLICATIONS

For suitable liquids which are thin, clean, non-explosive, non-aggressive, not containing solid particles or fibers.

For water supply systems and irrigation.

For heating, cooling, air-conditioning and circulation plants.

For civil, industrial and fire fighting applications.

As pressure boosting pump for central water systems with low pressure (follow local specifications if increasing network pressure).

FEATURES AND BENEFITS

- Compact design
- Easy and simple installation
- User-friendly operation
- Low noise level
- Reliable and robust construction
- Reliable water supply
- Built-in motor protection, dry running protection
- Back pull-out design which simplifies inspection & maintenance

OPERATING CONDITIONS

Flow range : Up to 156 m³/h
 Head range : Up to 55 metres
 Ambient temperature : Max. +50°C
 Liquid temperature range: 0°C to +90°C
 Total suction lift : Up to 8 metres

MOTOR

Motor type : TEFC 2-pole motor
 Ratings : 1 phase - 2.20 to 3.70 kW
 3 phase - 1.50 to 11.0 kW
 Rated speed : 2900 rpm
 Enclosure class : IP 55
 Insulation class : F
 Nominal voltage : 1 phase 230 V
 (Tolerance +5% / -15%) 3 phase 400 V
 Supply frequency : 50 Hz
 Duty / Rating : S1 / Continuous
 Direction of rotation: Clockwise as seen from the motor rear end

PUMPED LIQUIDS

These pumps are designed for liquids which are potable water, rain water or other than thin, clean, non-aggressive, non-explosive, not containing solid particles or fibres.

SECTIONAL DRAWING & MATERIALS

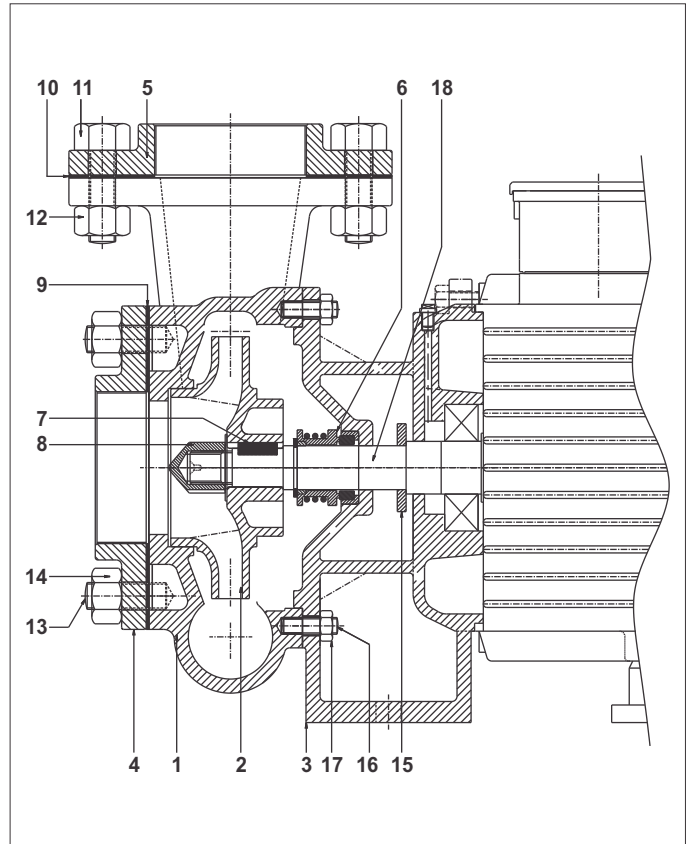

FIG.1 SECTIONAL DRAWING OF LBI PUMP

POS.	COMPONENT	MATERIAL
1	Volute	Cast iron
2	Impeller	Cast iron
3	Adaptor	Cast iron
4	Suction flange	Cast iron
5	Delivery flange	Cast iron
6	Mechanical shaft seal	Carbon/Ceramic/NBR
7	Key	Carbon steel
8	Impeller nut	Brass
9	Flange rubber packing (suction)	Rubber
10	Flange rubber packing (delivery)	Rubber
11	Hex bolt	Carbon steel
12	Hex nut	Carbon steel
13	Stud	Carbon steel
14	Hex nut	Carbon steel
15	Water thrower	Rubber
16	Stud	Carbon steel
17	Hex nut	Carbon steel
18	Shaft	Carbon steel*

Note: For Bronze impeller please add a subscript "B" to pump type.
 For example: LBI 101 for Cast iron impeller and LBI 101B for Bronze impeller.

* Stainless steel AISI 410 shaft is available on request.

PERFORMANCE CURVES

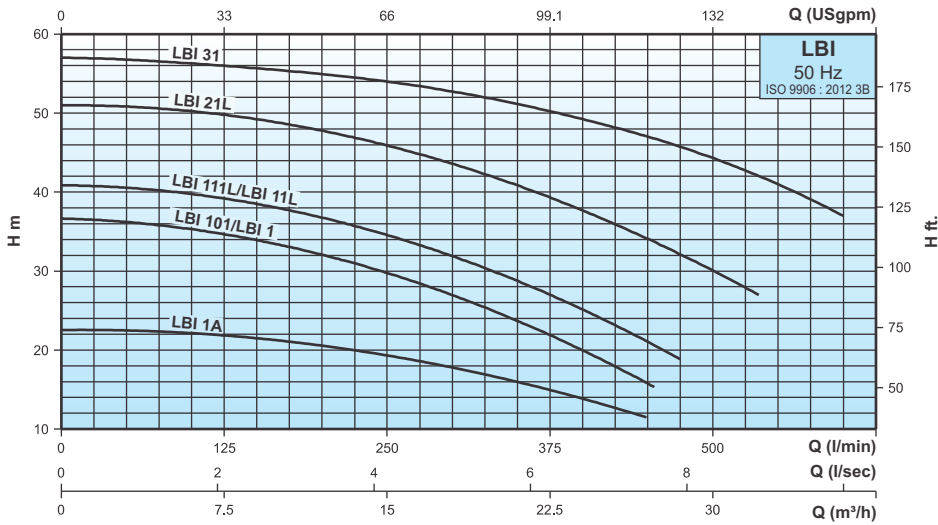

PUMP TYPE		MOTOR POWER		SUCTION SIZE	DISCHARGE SIZE
1 ~	3 ~	kW	HP		
-	LBI 1A	1.50	2.00	2"	2"
LBI 101	LBI 1	2.20	3.00	2"	1½"
LBI 111L	LBI 11L	3.70	5.00	2"	1½"
-	LBI 21L	5.50	7.50	2"	1½"
-	LBI 31	7.50	10.0	2"	1½"

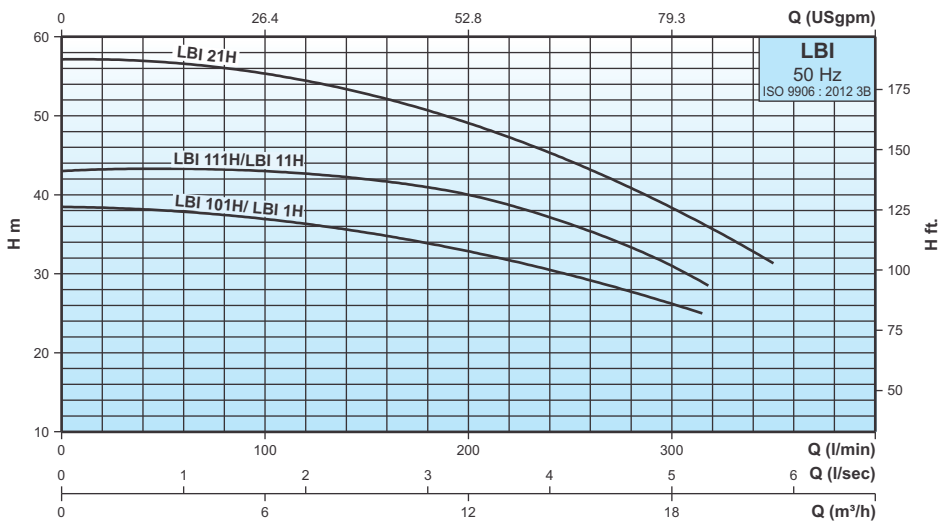

PUMP TYPE		MOTOR POWER		SUCTION SIZE	DISCHARGE SIZE
1 ~	3 ~	kW	HP		
LBI 101H	LBI 1H	2.20	3.00	2"	1½"
LBI 111H	LBI 11H	3.70	5.00	2"	1½"
-	LBI 21H	5.50	7.50	2"	1½"

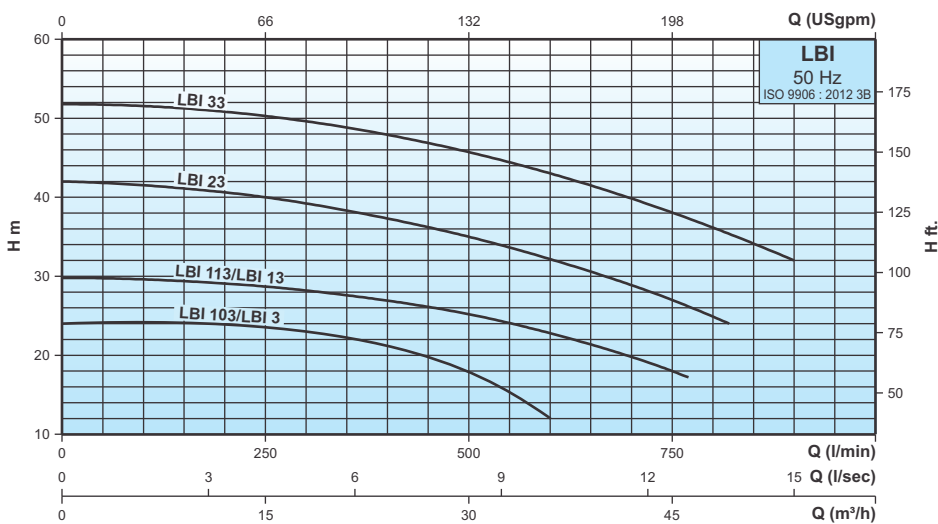

PUMP TYPE		MOTOR POWER		SUCTION SIZE	DISCHARGE SIZE
1 ~	3 ~	kW	HP		
LBI 103	LBI 3	2.20	3.00	2½"	2"
LBI 113	LBI 13	3.70	5.00	2½"	2"
-	LBI 23	5.50	7.50	2½"	2"
-	LBI 33	7.50	10.0	2½"	2"

PERFORMANCE CURVES

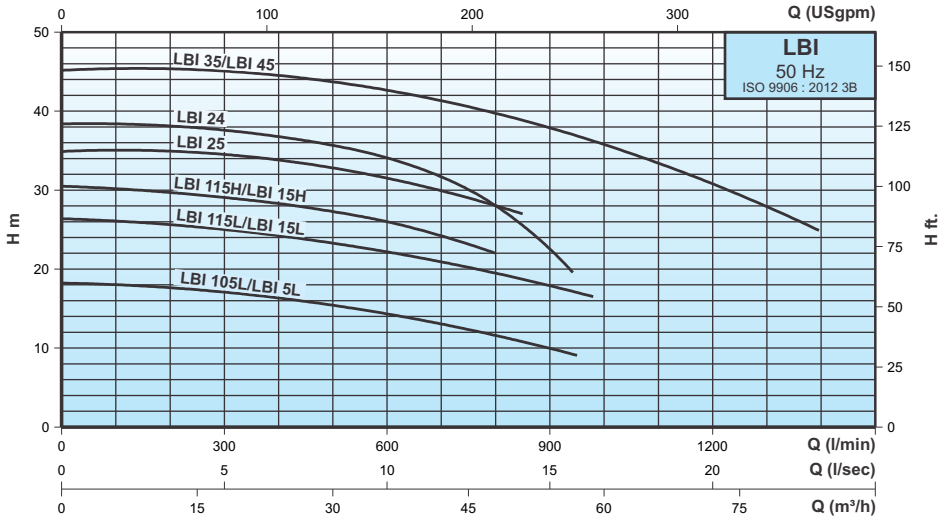

PUMP TYPE		MOTOR POWER		SUCTION SIZE	DISCHARGE SIZE
1 ~	3 ~	kW	HP		
LBI 105L	LBI 5L	2.20	3.00	3"	2½"
LBI 115L	LBI 15L	3.70	5.00	3"	2½"
LBI 115H	LBI 15H	3.70	5.00	3"	2½"
-	LBI 24	5.50	7.50	3"	2½"
-	LBI 25	5.50	7.50	3"	2½"
-	LBI 35	7.50	10.0	3"	2½"
-	LBI 45	9.30	12.5	3"	2½"

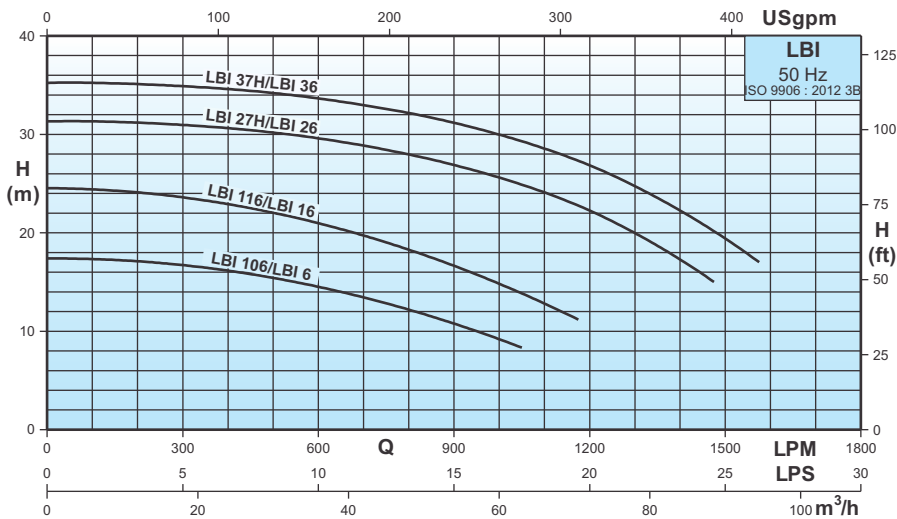

PUMP TYPE		MOTOR POWER		SUCTION SIZE	DISCHARGE SIZE
1 ~	3 ~	kW	HP		
LBI 106	LBI 6	2.20	3.00	3"	3"
LBI 116	LBI 16	3.70	5.00	3"	3"
-	LBI 27H	5.50	7.50	4"	3"
-	LBI 26	5.50	7.50	3"	3"
-	LBI 37H	7.50	10.0	4"	3"
-	LBI 36	7.50	10.0	3"	3"

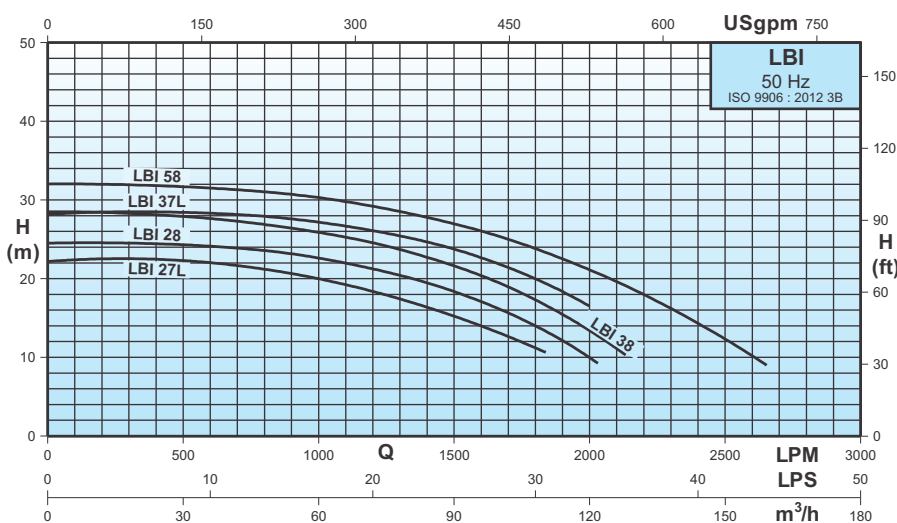

PUMP TYPE		MOTOR POWER		SUCTION SIZE	DISCHARGE SIZE
3 ~		kW	HP		
LBI 27L		5.50	7.50	4"	3"
LBI 28		5.50	7.50	4"	3"
LBI 37L		7.50	10.0	4"	4"
LBI 38		7.50	10.0	4"	4"
LBI 58		11.0	15.0	4"	4"

LUBI INDUSTRIES LLP

Near Kalyan Mills, Naroda Road, Ahmedabad-380 025, INDIA.

Phone : +91 - 79 - 61700100, Fax No. : +91 - 79 - 61700399.

Sales Enquiries: indsales@lubipumps.com, expsales@lubipumps.com

www.lubipumps.com

Product Improvement is a continuous process at 'LUBI'. The data given in this publication is therefore subject to revision.

01.00.071016.0046



ISO 9001



ISO 14001

Customer Care Number : 09824200800